

LAKELAND DRIVE OVER-GATE SYSTEM

- First thing to do once receiving your Cattle Gate is to open the Box and begin to lay out all parts to ensure there is nothing missing.
- Locate one of 54-111340-5 (Middle Tube Weldment), and two of 54-111348-5 (Cross Tube Weldment).
- Bolt these 3 sections together using hardware provided. Be sure they are aligned properly to ensure that when all the 5/8" rods are installed that they are all in line.
- Place the 54-111346-5 (Ramp Bottom) and the 54-111347-5 (Ramp Weldment) onto the Cross Tube Weldments as shown in Assembly Drawing. This will help keep everything stable during the remainder of the assembly.
- Place the two 54-111333-5 (Poly Mount & Chain Paint) on each end of the Cross Tube Weldments and lock into place using the 54-111321-5 (Large Tube Ring) and the setscrews provided.
- Slide one of 54-111330-5 (Spring Telescope Tube) onto each 54-111352-5 (Leg Extensions) as shown in assembly drawing.
- Place all four Leg Extensions into the Upright Weldments as shown in assembly to help stabilize the Gate during Assembly, and secure into place using hardware provided. Be sure to have two Leg Extensions with spring attachments on the same side of Gate.
- Install the 3703-04-0050 (UHMW Wheel) onto the 54-111333-5 Tube on same side as the spring attachments.
- Place both the 54-111332-5 Tubes onto the Cross Tube weldment as shown in drawing and secure using hardware provided.
- The Snap-On Chain Link can be installed onto chain welded to top of 54-111333-5 which is used to attach to chain link welded to top of 54-111332-5. This is used to keep gate from being pushed over when not in use.
- The two Gate Rails (54-111442-5) can be installed using proper hardware, hand tighten gate rail hardware first and then use two 5/8" rods to make sure the gate rails are centered and the rods are perfectly vertical and then tighten down hardware and all 5/8" rods (54-111353-5) can be installed into Gate rails.
- Now that main frame components are installed the chain and springs can be installed onto the spring attachment tubes and ran over top of the UHMW Wheel.
- The chain is attached to 54-111348-5 using hardware provided by placing a chain link (approximately middle link) into middle of tube and fastening into place.
- The springs can be tensioned at this point by moving 54-111330-5 along the Telescoping tubes and then fastening down using bolts provided, or by shortening the chain length on the spring. The stronger the tension on the spring the faster the gate will come back up but it will also take more pressure to push it over.
- The Grease Zerks can now be installed as shown in Assembly Drawing.
- There are 2 decals which can be installed onto 54-111333-5
- There are 6 plastic tube plugs (four 2" plugs and two 1 1/2") which are to be installed into all 6 tubes as shown to prevent rain from getting into tubes. If plugs are not installed, rain can run down into the tubes and split these tubes when the water freezes in the bottoms of the tubes.

LAKELAND DRIVE OVER-GATE SYSTEM

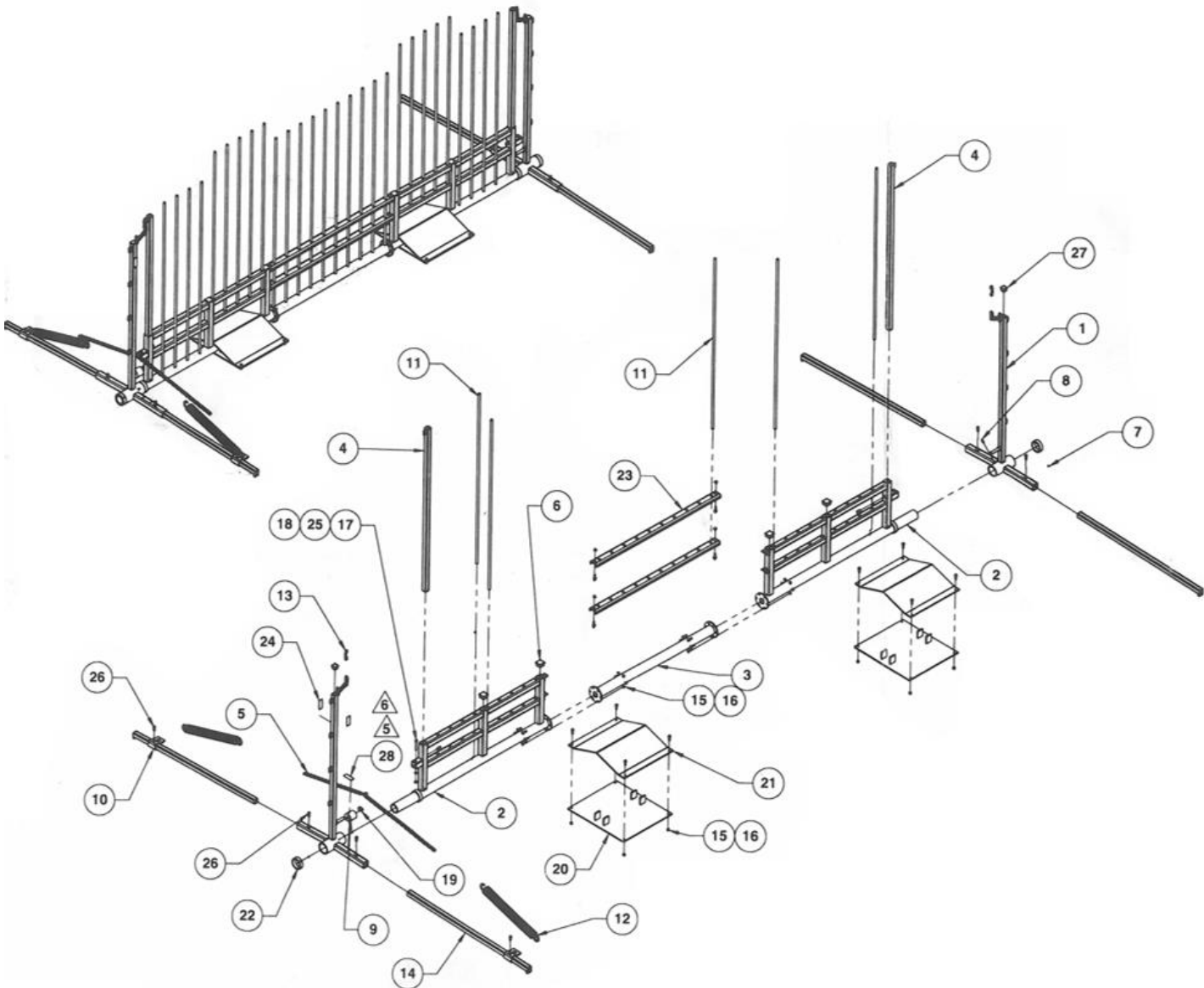

LAKELAND DRIVE OVER-GATE SYSTEM

NO	PART NUMBER	SZ	DESCRIPTION	QTY
1	54-111333-5	1	POLY MOUNT & CHAIN PAINT	2
2	54-111348-5	1	14' CROSS TUBE WELDMENT	2
3	54-111340-5	1	MIDDLE TUBE WELDMENT	1
4	54-111332-5	1	END & CHAIN TUBE WELD	2
5	54-111334	1	GATE SPRING CHAIN	1
6	3703-00-0049	C	PLASTIC PLUG - 2" SQUARE	4
7	4020-10C2332		SETSCR-HX SKT 5/16 X 3/8	2
8	6215-00-0614	C	GREASE ZERK - 1/4-28 STR.	2
9	3703-04-0050	1	UHMW WHEEL	1
10	54-111330-5	1	SPRING TELESCOPE PAINT	2
11	54-111353-5	1	CUT WIRE 58" PAINT	28
12	54-111358-1	1	ASSIST SPRING 14' & 16'	2
13	6201-00-0001	1	BOLT SNAP - PLTD STEEL	2
14	54-111352-5	1	LEG EXTENSION WELD	4
15	4046-13C0235	C	NUT-WHIZ, FLG 3/8 UNC GR.5	24
16	4024-22C2510	C	BOLT-WHIZ 3/8 X 1 1/4 UNC GR.5	24
17	4001-22C2722	C	BLT-HX 7/16 X 3 GR. 5	1
18	4030-21C0250	C	NUT-HEX 7/16 UNC PLTD. GR.5	1
19	4055-02C0305	C	NUT-LOCK UNI-TRQ 3/4 UNC	1
20	54-111347-5	1	RAMP WELDMENT PAINT	2
21	54-111346-5	1	RAMP BOTTOM PAINT	2
22	54-111321-5	1	LARGE TUBE RING W HOLE	2
23	54-111442-5	1	GATE RAIL 49"	2
24	9005-54-0179	1	DECAL-PUSH'N'DRIVE GATE	2
25	5000-03-0438	C	WASHER-LOCK 7/16 DIA. PTD.	1
26	4018-10C2888	C	SETSCR-SQ HD 1/2 X 1	8
27	3703-00-0016	C	PLASTIC PLUG - 1 1/2" SQUARE	2